

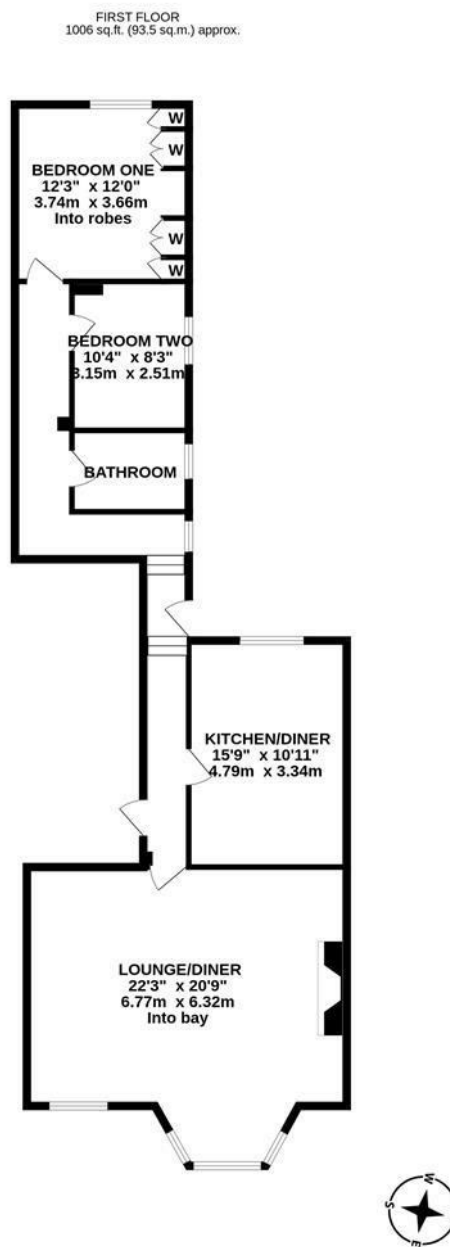

PERIOD FEATURES & NO ONWARD CHAIN! This two bedroom conversion apartment is ideally located on Eslington Terrace, right in the heart of Brandling Village Conservation Area, Jesmond! Eslington Terrace, situated close to the parade of shops on Clayton Road, Jesmond Metro Station as well as Exhibition Park and the café culture of Jesmond is also ideally placed within walking distance to Newcastle City Centre itself.

Boasting over 1,000 Sq ft, the accommodation briefly comprises: communal entrance door with secure telephone entry system and stairs to first floor; 22ft lounge diner with walk in bay, separate window, feature fireplace, ornate cornice and decorative ceiling rose; kitchen diner with fitted units and work surfaces; two bedrooms, bedroom one with fitted wardrobe storage; bathroom complete with three piece suite including step in shower. Externally to the rear, a shared parking area with wall boundaries. Offered to the market with no onward chain, early viewings are advised.

First Floor Conversion Apartment | 1,006 Sq ft (93.5m²) | Two Bedrooms | 22ft Lounge Diner | Kitchen Diner | Bathroom | Period Features | No Onward Chain | Leasehold - Share of Freehold with 958 Years Remaining | Service Charge Ad-Hoc | Council Tax Band C | EPC: C



Offers Over £240,000

IMPORTANT NOTE: These particulars and the descriptions and measurements herein do not constitute representation and whilst every effort has been made to ensure accuracy, this cannot be guaranteed.

